

This custom kit is manufactured by Snowbear Limited to fit:

CHEVROLET TAHOE 1500 / AVALANCHE 1500

(2WD)&(4 x 4) YEAR 2007

GMC YUKON 1500 / SIERRA 1500 / SILVERADO 1500

(2WD) & (4 x 4) YEAR 2007

REMOVE EXISTING BOLTS #8
REPLACE WITH LONGER BOLTS
ITEMS #4 AND #6

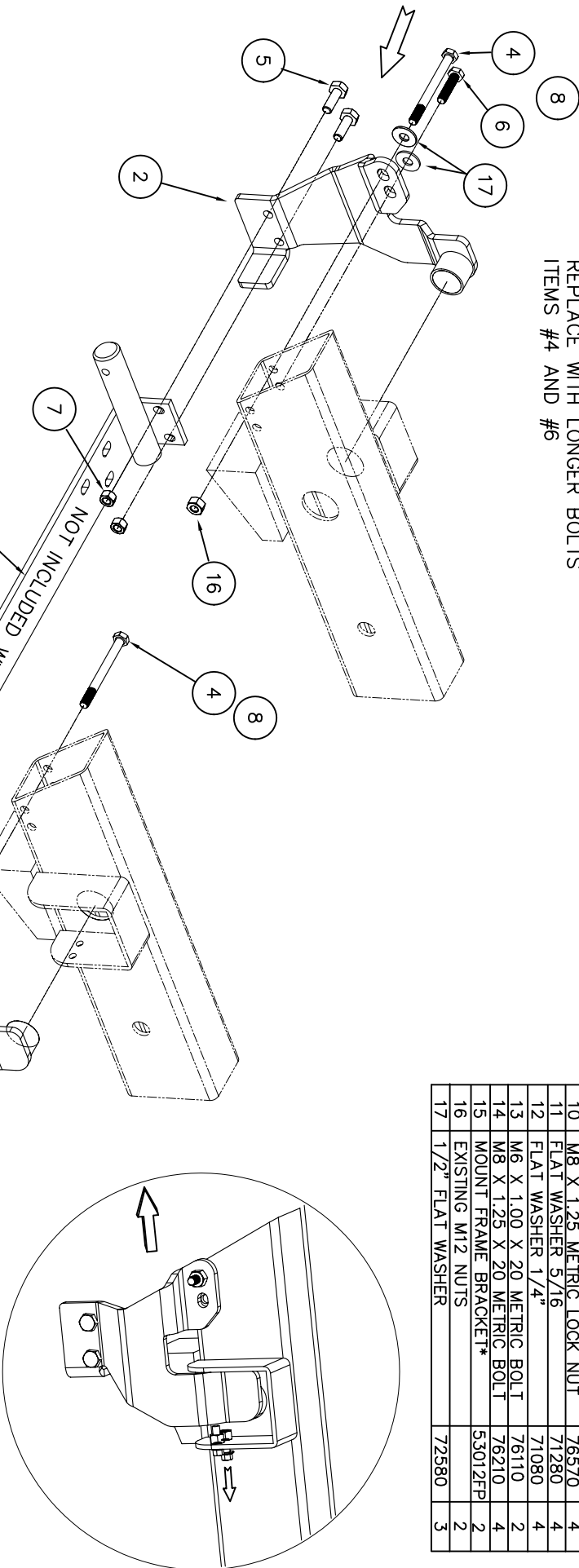

NOTE: BOTTOM BUMPER SKIRT MUST
BE REMOVED TO ALLOW SUFFICIENT
CLEARANCE FOR CROSS MEMBER
ATTACHMENT (USE 10 MM SOCKET)
APPLICABLE TO ALL VEHICLES

NOTE: TAHOE/AVALANCHE AND
YUKON VEHICLES REQUIRE WHEEL
WELL PLASTIC BRACKETS REMOVED.
FOR ASSEMBLY DETAILS SEE PAGE
TWO OF THIS MANUAL

ITEM	DESCRIPTION	PART #	QTY.
1	CROSS MEMBER	5XM5	1
2	NOT INCLUDED IN KIT, PURCHASE SEPARATELY		
3	L.H. SUPPORT ASSEMBLY	53012L	1
4	R.H. SUPPORT ASSEMBLY	53012R	1
5	M12 x 1.75 x 130	76455	2
6	HEX BOLT 1/2-13 x 1 1/2	72510	4
7	M12 x 1.75 x 55 METRIC BOLT	76450	1
8	LOCKING HEX NUT 1/2-13	72595	4
9	EXISTING BOLTS		3
10	M6 X 1.00 METRIC LOCK NUT	76195	2
11	M8 X 1.25 METRIC LOCK NUT	76570	4
12	FLAT WASHER 5/16	71280	4
13	FLAT WASHER 1/4"	71080	4
14	M6 X 1.00 X 20 METRIC BOLT	76110	2
15	M8 X 1.25 X 20 METRIC BOLT	76210	4
16	MOUNT FRAME BRACKET*	53012FP	2
17	EXISTING M12 NUTS		2
17	1/2" FLAT WASHER	72580	3

SIDE VIEW-LOOSEN INSIDE
BOLT TO ALLOW MOUNT
ASSEMBLY

This custom kit is manufactured by Snowbear Limited to fit:

CHEVROLET TAHOE 1500 / AVALANCHE 1500

(2WD)&(4 x 4) YEAR 2007

GMC YUKON 1500 / SIERRA 1500 / SILVERADO 1500

(2WD) & (4 x 4) YEAR 2007

NOTE:
THIS PROCEDURE IS NOT REQUIRED
FOR SIERRA/SILVERADO AS THEY
ARE NOT EQUIPPED WITH PLASTIC
BRACKETS.

ITEM	DESCRIPTION	PART #	QTY.
1	CROSS MEMBER	5XM5	1
* NOT INCLUDED IN KIT, PURCHASE SEPARATELY			
2	L.H. SUPPORT ASSEMBLY	53012L	1
3	R.H. SUPPORT ASSEMBLY	53012R	1
4	M12 x 1.75 x 130	76455	2
5	HEX BOLT 1/2-13 x 1 1/2	72510	4
6	M12 x 1.75 x 55 METRIC BOLT	76450	1
7	LOOKING HEX NUT 1/2-13	72595	4
8	EXISTING BOLTS		3
9	M6 X 1.00 METRIC LOCK NUT	76195	2
10	M8 X 1.25 METRIC LOCK NUT	76570	4
11	FLAT WASHER 5/16"	71280	4
12	FLAT WASHER 1/4"	71080	4
13	M6 X 1.00 X 20 METRIC BOLT	76110	2
14	M8 X 1.25 X 20 METRIC BOLT	76210	4
15	MOUNT FRAME BRACKET*	53012FP	2
16	EXISTING M12 NUTS		2
17	1/2" FLAT WASHER	72580	3

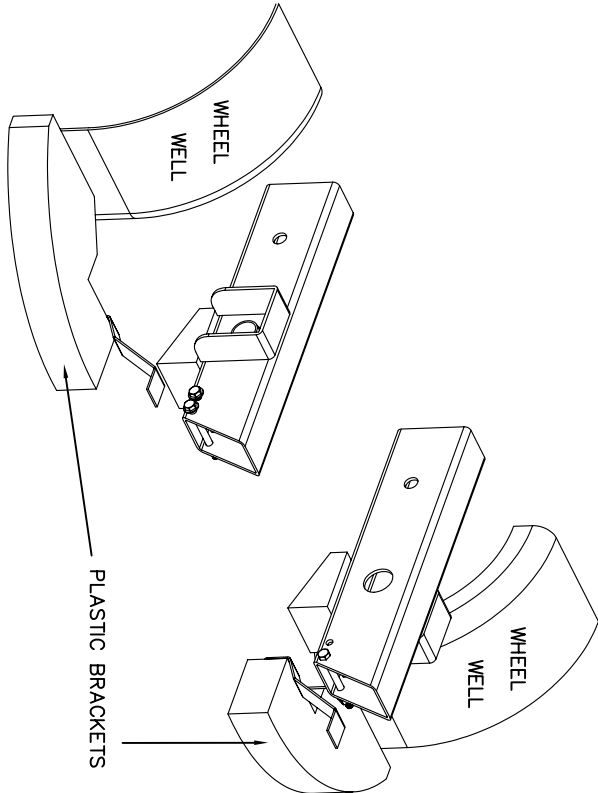

REMOVE PLASTIC BRACKET WITH
10 MM AND 7 MM SOCKET

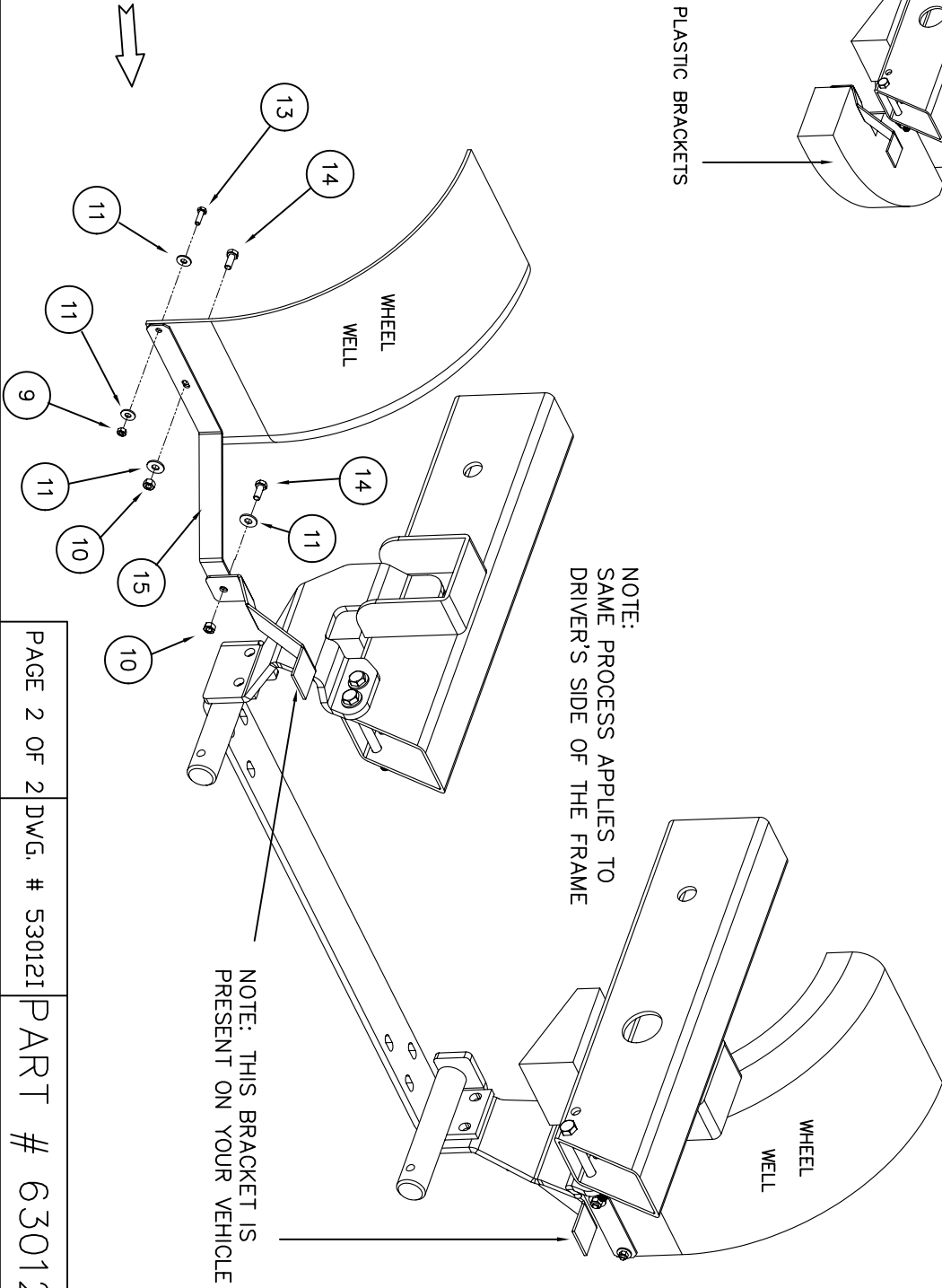
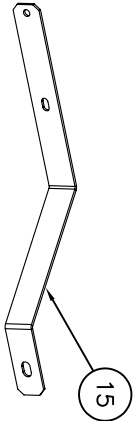

REPLACE PLASTIC BRACKET WITH
ITEM # 15 MOUNT FRAME BRACKET

NOTE: THIS BRACKET IS
PRESENT ON YOUR VEHICLE